

PROJECT TITLE: 16x8x12 COMFORT BLOCK UNIT - STRETCHER
DRAWING TITLE: CROSS SECTIONAL PROPERTIES - VERTICAL SPAN WALL

REVISION
01-101116

16-INCH COMFORT UNIT – HORIZONTAL SECTION PROPERTIES (VERTICAL SPAN)

| UNIT | GROUT SPACING (INCH) | MORTAR BEDDING (6) | NET CROSS SECTION PROPERTIES (1),(3),(5) | | | AVERAGE CROSS-SECTIONAL PROPERTIES (2),(4),(5) | | | | |
|------|----------------------|--------------------|--|---------------|---------------|--|---------------|---------------|-------------|------|
| | | | Anet (IN ² /FT) | Inet (IN4/FT) | Snet (IN3/FT) | Aavg (IN ² /FT) | Iavg (IN4/FT) | Savg (IN3/FT) | Γ avg (IN.) | |
| NG | HOLLOW | NO GROUT | FACE SHELL | 81.43 | 2,505.90 | 313.24 | 111.11 | 2,823.59 | 352.95 | 5.04 |
| FG | HOLLOW | FULL GROUT | FULL | 111.23 | 2,521.38 | 315.17 | 131.53 | 2,833.04 | 354.13 | 4.64 |
| 12G | HOLLOW | 12 | FACE SHELL | 100.14 | 2,515.64 | 314.46 | 121.33 | 2,828.32 | 353.54 | 4.83 |
| 18G | HOLLOW | 18 | FACE SHELL | 95.93 | 2,595.51 | 324.44 | 121.59 | 2,918.27 | 361.45 | 4.90 |
| 24G | HOLLOW | 24 | FACE SHELL | 91.05 | 2,527.91 | 315.99 | 117.10 | 2,851.26 | 356.41 | 4.93 |
| 30G | HOLLOW | 30 | FACE SHELL | 88.77 | 2,507.16 | 313.39 | 114.18 | 2,805.16 | 350.64 | 4.96 |
| 36G | HOLLOW | 36 | FACE SHELL | 87.83 | 2,520.42 | 315.05 | 114.62 | 2,830.86 | 353.86 | 4.97 |
| 42G | HOLLOW | 42 | FACE SHELL | 88.05 | 2,561.19 | 320.15 | 116.02 | 2,876.53 | 359.56 | 4.98 |
| 48G | HOLLOW | 48 | FACE SHELL | 86.79 | 2,537.75 | 317.23 | 114.55 | 2,850.10 | 356.26 | 4.99 |
| 54G | HOLLOW | 54 | FACE SHELL | 85.81 | 2,517.72 | 314.97 | 113.14 | 2,822.96 | 352.87 | 5.00 |
| 60G | HOLLOW | 60 | FACE SHELL | 85.37 | 2,521.49 | 315.19 | 113.27 | 2,831.37 | 353.92 | 5.00 |
| 66G | HOLLOW | 66 | FACE SHELL | 85.88 | 2,551.81 | 318.98 | 114.50 | 2,865.14 | 358.14 | 5.00 |
| 72G | HOLLOW | 72 | FACE SHELL | 85.23 | 2,537.05 | 317.13 | 113.69 | 2,849.67 | 356.21 | 5.01 |

FOOTNOTES:

1. NET CROSS SECTIONAL PROPERTIES DETERMINED AT HORIZONTAL PLANE THROUGH UNIT AT TOP, AT MINIMUM BEDDED FACE SHELL THICKNESS.
2. AVERAGE CROSS SECTIONAL PROPERTIES DETERMINED AS AVERAGE FROM TWO HORIZONTAL PLANES AT TOP AND BOTTOM OF UNIT, INCLUDING CROSS WEBS AND GROUT WHERE PRESENT.
3. ALL FACE SHELLS MORTARED , NO CROSS WEBS EXCEPT BONDED WEBS ADJACENT TO GROUTED CORE WHERE PRESENT. NOTE CROSS WEBS DEPRESSED FROM TOP SURFACE OF UNIT.
4. ALL FACE SHELLS AND CROSS WEBS.
5. CENTER CORES CONTAIN GROUT WHERE INDICATED, "EXTERIOR" CORES OPEN OR HAVE INSULATION.
6. APPIES TO NET SECTION PROPERTIES. AVERAGE SECTION PROPERTIES INCLUDE FACE SHELLS AND WEB COMPONENTS.

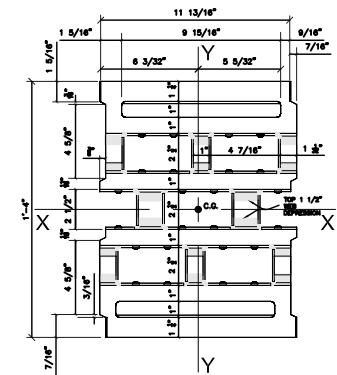

DiBartolomeo Engineering, P.C.
STRUCTURAL CONSULTANTS

717 E. Genesee Street • Suite 200 • Syracuse, New York 13210
(315) 478-4911 FAX (315) 478-5139
Info@dbartengineering.com

WHILE REASONABLE CARE HAS BEEN USED TO ENSURE THE INFORMATION CONTAINED HEREIN IS ACCURATE AND COMPLETE INSOFAR AS IT DESCRIBES CERTAIN SECTION PROPERTIES, GENEST CONCRETE PRODUCTS, DIBARTOLOMEO ENGINEERING, P.C., AND THEIR SHAREHOLDERS, OFFICERS AND EMPLOYEES, DISCLAIM ANY RESPONSIBILITY OR LIABILITY ARISING FROM OR RELATED TO THE USE OF THE INFORMATION CONTAINED HEREIN. THE LIMITED INFORMATION CONTAINED HEREIN MUST BE UTILIZED BY A QUALIFIED AND LICENSED DESIGN PROFESSIONAL RESPONSIBLE FOR THE APPLICABILITY, LIMITATIONS AND SIGNIFICANCE OF THIS INFORMATION IN THE CONTEXT OF ANY PROJECT.